

# MM8300##E HENDERSON LED ILLUMINATED MIRROR 500 X 700 X 37mm

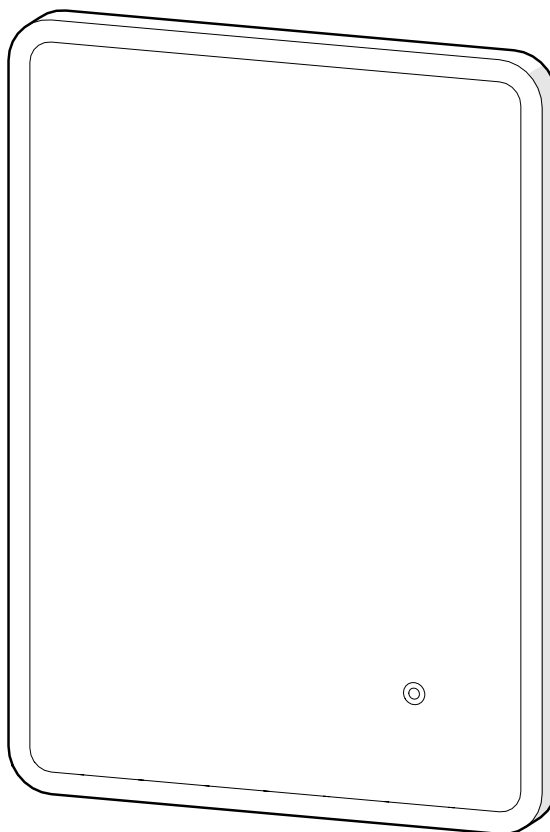

**ALL ILLUSTRATIONS OF THE PRODUCT ARE FOR REFERENCE ONLY. COMPONENTS SUPPLIED WITH INDIVIDUAL PRODUCTS MAY DIFFER**

**ALL PRODUCT DIMENSIONS DETAILED IN THIS INSTALLATION AND MAINTENANCE MANUAL ARE APPROXIMATE**

## **CONTACT DETAILS (UK)**

Croydex  
Central Way  
Andover  
Hampshire  
SP10 5AW  
UK

Tel: +44 (0)1264 365881  
Email: [info@croydex.co.uk](mailto:info@croydex.co.uk)

[www.croydex.com](http://www.croydex.com)

## **CONTACT DETAILS (EU)**

MIL  
Unit 8 Purcellsinch Ind Est  
Dublin Road  
Kilkenny  
R95 HP71  
Ireland



**ALWAYS CHECK THE PACKAGING FOR FIXINGS AND PARTS BEFORE RECYCLING OR DISPOSAL.**

**PLEASE READ THROUGH AND FULLY UNDERSTAND THE INSTRUCTION LEAFLET BEFORE STARTING THE INSTALLATION OF THIS MIRROR.**

**ENSURE YOU HAVE ALL THE FIXINGS AND PARTS BEFORE ATTEMPTING TO ASSEMBLE OR FIT THIS PRODUCT.**

# SECTION 1 - INTRODUCTION

Thank you for purchasing this Croydex product. Please follow the fixing and care instructions to ensure that your product is fitted safely and that it retains its high quality finish. **PLEASE RETAIN THIS MANUAL FOR FUTURE REFERENCE.**

## SAFETY & PRODUCT CARE

1. **ALWAYS** take care when using power tools, particularly if there is any water in the working area.
2. **ALWAYS** wear eye protection when using power tools.
3. **ALWAYS** check for pipes and cables before drilling into walls.
4. **ALWAYS** use a ceramic drill bit when drilling into tiled surfaces.
5. **ALWAYS** use a drill bit that is suitable for the surface that is being drilled.
6. The wall plugs supplied are for use on solid walls only. For cavity walls or plasterboard **ALWAYS** use specialist fixings that are suitable for the type of wall construction.
7. **DO NOT** use abrasive or chemical cleaners as these may damage the product.
8. **DO NOT** strike the mirror with hard or sharp objects.
9. **DO NOT** drill on the grout line of tiles.
10. **ALWAYS** use masking tape on tiles surfaces.

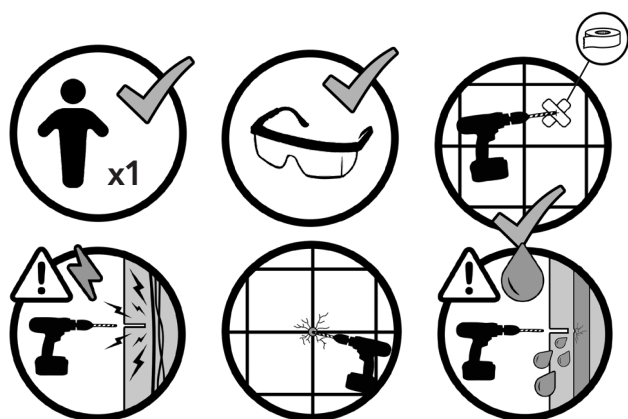

## IMPORTANT INSTALLATION INFORMATION

THIS IS A CLASS 1 APPLIANCE AND MUST BE CONNECTED TO EARTH

HAZARDOUS VOLTAGES INSIDE – DO NOT OPEN SEALED UNITS

THERE ARE NO USER REPLACEABLE PARTS IN THE MIRROR

In accordance with Statutory Instrument 2004 No. 3210 - The Building (Amendment) (No.3) Regulations 2004, any work, other than repair/replacements, in a room where there is water (e.g. kitchen, bathroom, etc.) must be either:

- Carried out by an electrician who is a member of a competent person self certification scheme who will certify the work complies with the Building Regulations and you do not need to notify your local authority.

OR

- Carried out after prior notification to the Local Authority Building Control Department, which has responsibility for ensuring that the work is inspected and tested.

## TOOLS REQUIRED

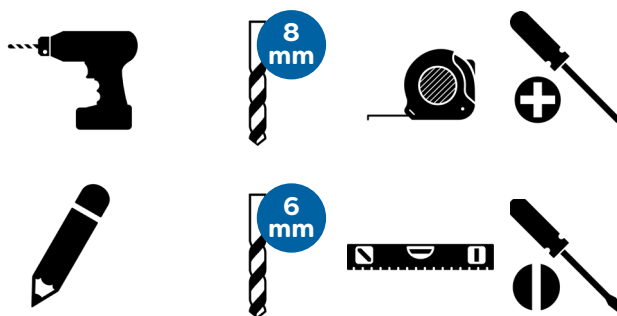

## WALL FIXING PACK

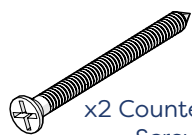

x2 Countersink Screw



x2 Hang n Lock Wall Plug



x1 L-Bracket

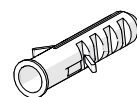

x1 Wall Plugs

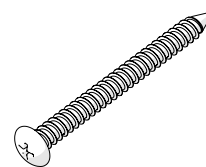

x1 Pan-Head Screw

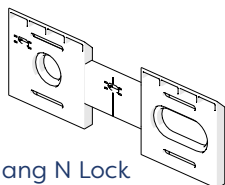

x1 Hang N Lock Bracket - Left



x2 Cam

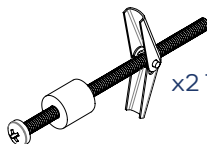

x2 Toggle Bolts

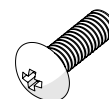

x1 L-Bracket

## IMPORTANT WARRANTY INFORMATION

In accordance with Statutory Instrument 2004 No. 3210 - The Building (Amendment) (No.3) Regulations 2004, the installer must give the occupier of the premises in which this product has been installed a certificate to confirm that the requirements of regulations 4 and 7 have been satisfied, or the installation of this product must be inspected and tested by the Local Authority Building Control Department who will issue a compliance certificate.

A copy of this certificate may be required for certain warranty claims. Failure to provide a copy of the certificate may invalidate the warranty.

This does not affect your statutory rights

We recommend that you make yourself aware of the Regulations before you undertake any work and if you require clarification you should contact your Local Authority Building Control Department.

## POSITIONING THE MIRROR

1. The mirror is rated IP44 and must only be installed with the connection to the domestic mains electrical supply in the Outside Zones, as shown in **Fig. 1**.
2. Ensure that the access to the domestic mains electrical supply is located behind the intended mounting position for the mirror and unobstructed by the mounting brackets.

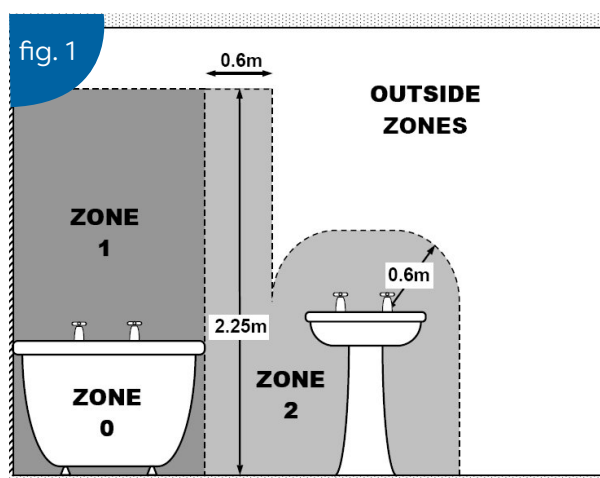

## SECTION 2 - MOUNTING USING HANG N LOCK

1. Place the Hang 'N' Lock bracket onto the support slot on the back of the mirror. Make a note of the distance from the bottom edge of the bracket to the top edge of the mirror - this will help you when mounting your mirror.

(See Fig. 2)

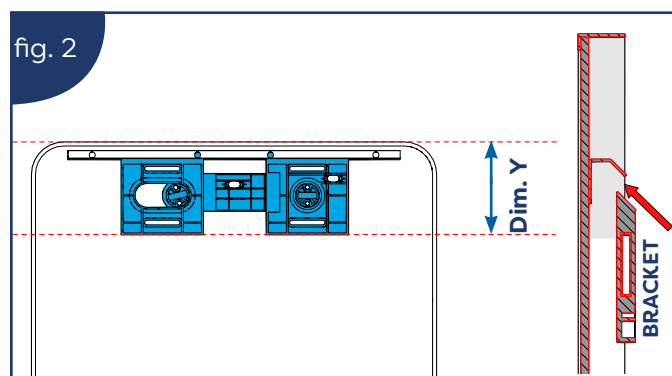

2. Carefully hold your mirror in the desired location on the wall. Using a pencil, draw a reference line along the top edge of the mirror. Use the bracket distance you measured earlier to create a reference line where the bottom of your Hang 'N' Lock bracket will be.

(See Fig. 3)

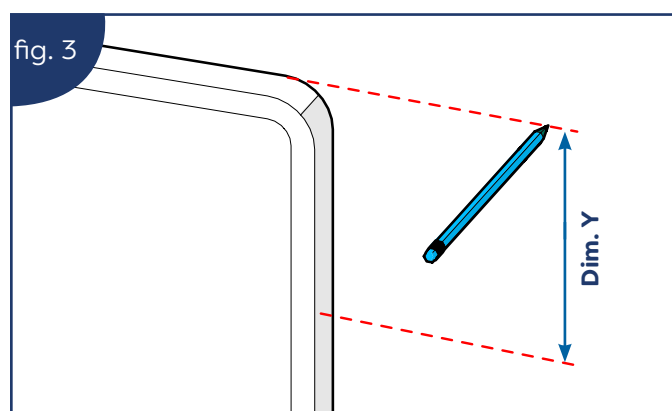

3. Place the bottom edge of the Hang 'N' Lock bracket onto the lower reference line. Mark the hole centres with a pencil.

(See Fig. 4)

**Note: Check the cams are oriented correctly with the countersink holes positioned at the top.**

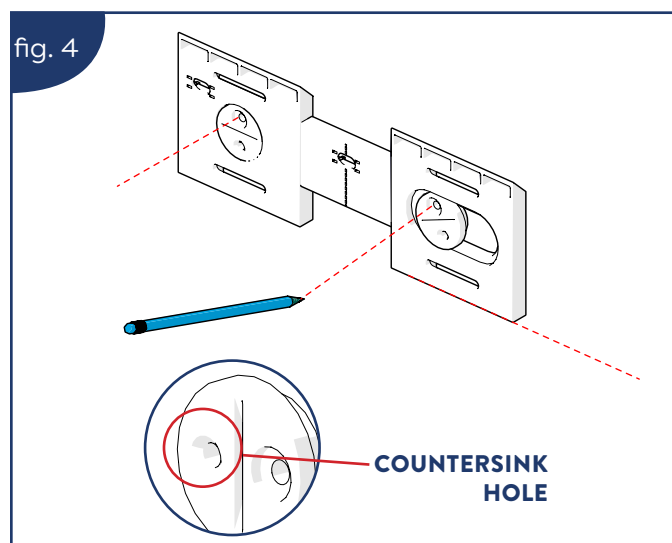

4. Drill the marked holes to a depth of 45mm. Insert the wall plugs level with the surface of the wall. **If you are fitting to a tiled surface, insert the wall plugs below the surface of the tile to avoid cracking the tiles.** Wall plugs supplied are for use on solid walls only. (See Fig. 5)

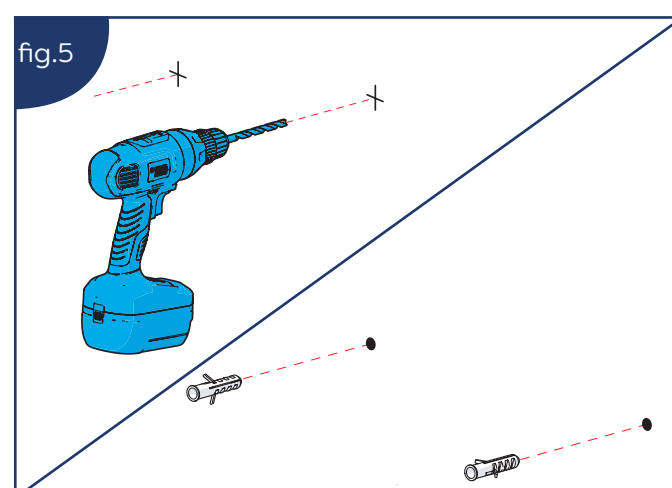

### NOTE:

For **CAVITY WALLS** or **PLASTERBOARD** use toggle bolts provided. See **SECTION 3 - Toggle Bolt Installation**. Continue to **Step 6**.

5. Insert the countersink screws through the Hang 'N' Lock cams and loosely secure the Hang 'N' Lock bracket to the wall.

(See Fig. 6)

**Note:** Check the cams are oriented correctly with the countersink holes positioned at the top.

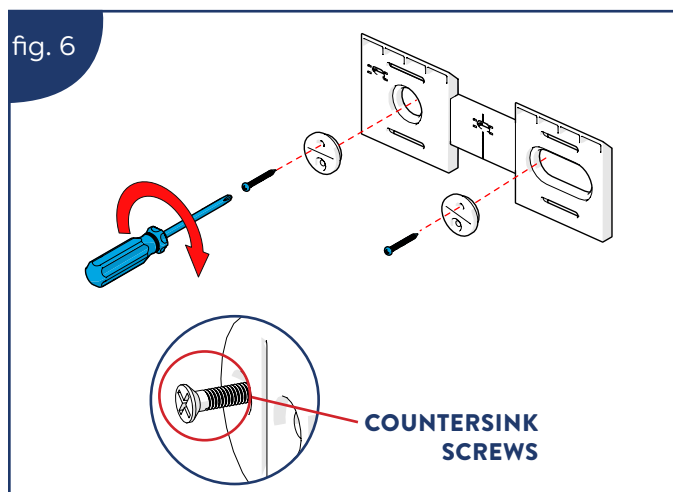

6. With the Hang 'N' Lock bracket loosely attached to the wall, adjust for height and level by rotating the cams with a flat head screwdriver. Use the attached spirit level as a guide. Once complete, fully tighten the mounting screws to securely fix the bracket into position.

(See Fig. 7)

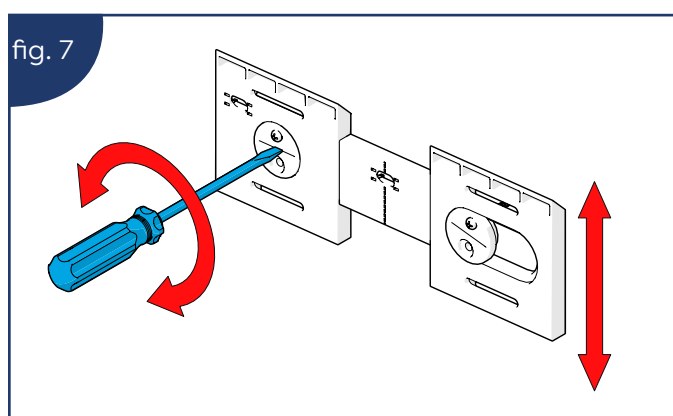

7. Hang the mirror onto the Hang 'N' Lock bracket. Ensure the mirror has securely located onto the bracket before letting go.

(See Fig. 8)

**Note:** If the mirror is not vertical, remove the mirror, loosen bracket screws and repeat Step 6.

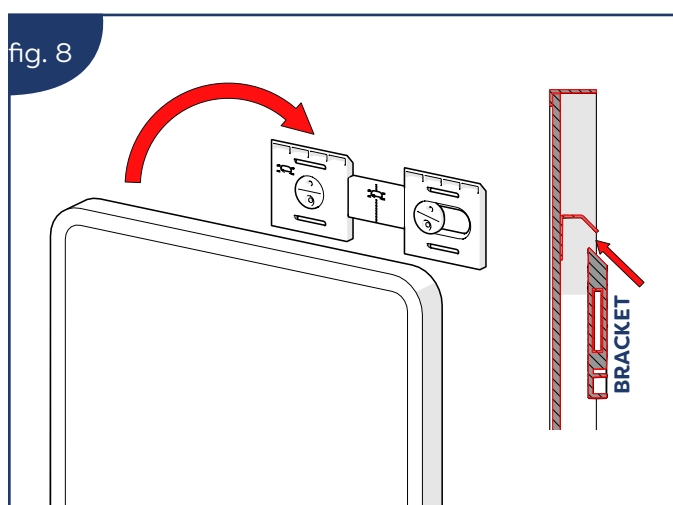

**Note:** The position of the mirror can be adjusted by sliding left or right along the bracket.

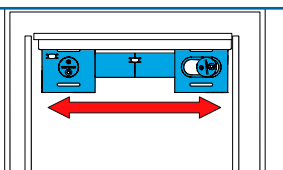

8. Place the L bracket over the threaded rivet located at the bottom of the mirror. Using a pencil mark the position of the L bracket onto the wall.

(See Fig. 10)

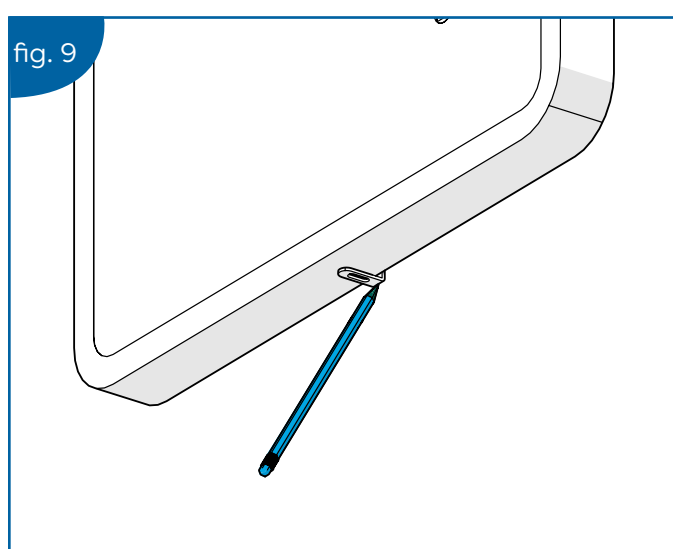

9. Gently remove the mirror, place the L bracket on the mark and drill a hole in the centre of the slot on the wall. Insert the wall plug and lightly screw the bracket to the wall, allowing the bracket to be moved up and down the slot.

(See Fig. 10)

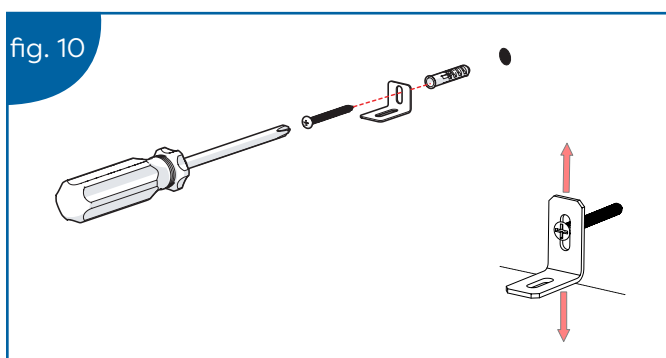

**\* Refer to SECTION 4 - CONNECTING THE ELECTRICAL SUPPLY before proceeding to step 10 and fastening the mirror. \***

10. With the mirror in place, secure the L bracket to the mirror using the bolt provided. (See Fig. 12)

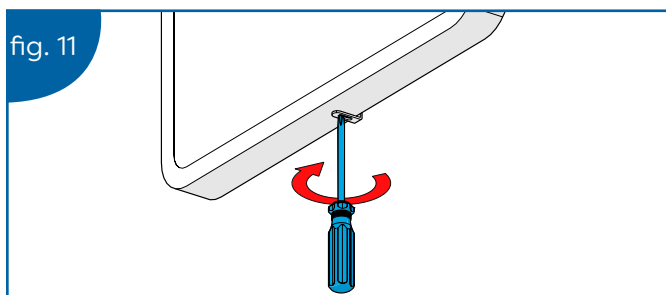

## SECTION 3 - TOGGLE BOLT INSTALLATION

### TOGGLE BOLT INSTALLATION

During Step 4 & 5, if toggle bolts are used, follow the steps bellow:

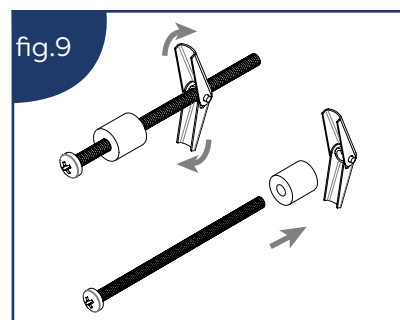

i) Drill marked holes with an 11mm drill bit.

ii) Dismantle the toggle bolt. (See Fig. 9)

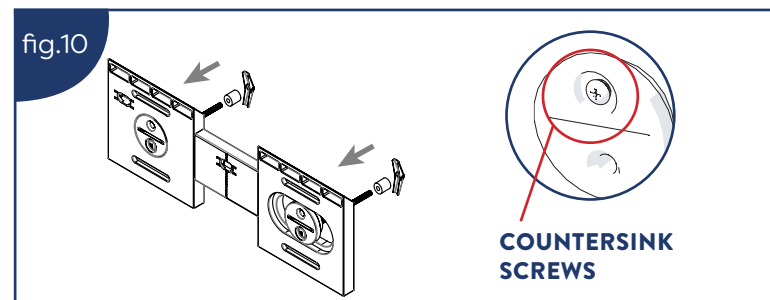

iii) Insert the threaded bolt through the Hang 'N' Lock cams and reattach the plugs and spring.

(See Fig. 10)

**Note: Ensure the screws go through the holes with the counter-bore holes.**

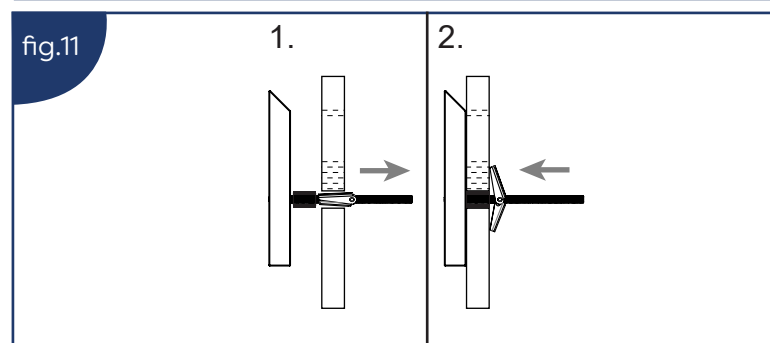

iv) Push the spring loaded wall braces on the toggle bolts through the drilled holes and loosely secure the Hang 'N' Lock bracket to the wall. (See Fig. 11)

**\*Continue from STEP 6 on the main instruction leaflet\***

## SECTION 4 - CONNECTING THE ELECTRICAL SUPPLY

REMOVE THE MIRROR FROM THE WALL.

**ENSURE THAT THE DOMESTIC ELECTRICAL MAINS SUPPLY TO WHICH THE CABINET IS TO BE CONNECTED IS TURNED OFF.**

Connect the flexible mains supply cable on the mirror to the domestic electrical mains supply ensuring that:

- The Live (Brown) conductor is connected to the Live on the domestic electrical mains supply.
- The Neutral (Blue) conductor is connected to the Neutral on the domestic electrical mains supply.
- The Earth (Green/Yellow) conductor is connected to the Earth/Ground on the domestic electrical mains supply.

**Note: Connection of the product to the domestic electrical mains supply must only be carried out by a Building Regulations Part P certified electrician or must be checked by your Local Authority Building Control Department.**

Hang the mirror and secure the L bracket to the mirror using the bolt provided. **(Step 10)**

## SECTION 5 - OPERATING THE MIRROR

**FOLLOW THESE INSTRUCTIONS TO OPERATE THE MIRROR**

**FROM OFF:**

1. Single **SHORT TOUCH AND RELEASE** to turn **ON** light and activate anti-fog function.
2. Single **SHORT TOUCH AND RELEASE** to turn **OFF** light and de-activate anti-fog function.

Colour temperature: **6400K**

## SECTION 6 - DECLARATION OF CONFORMITY



**THIS PRODUCT COMPLIES WITH THE REQUIREMENTS OF**

The UK Electrical Equipment (Safety) Regulations 2016

The UK Electromagnetic Compatibility Regulations 2016

The UK Restriction of the Use of Certain Hazardous Substances in Electrical and Electronic Equipment Regulations 2012

The EU Low Voltage Directive (LVD) 2014/35/EU

The EU Electromagnetic Compatibility (EMC) Directive 2014/30/EU

The EU Restriction of Hazardous Substances (RoHS) Directive 2011/65/EU

The following UKCA and CE Declarations of Conformity can be requested from [info@croydex.co.uk](mailto:info@croydex.co.uk) or downloaded from [www.croydex.com](http://www.croydex.com):

**UKCA electrical safety and EMC (UKCA-DoC-00001-Safety-EMC.pdf)**

**UKCA RoHS (UKCA-DoC-00001-RoHS.pdf)**

**EU CE LVD and EMC (CE-DoC-00001-LVD-EMC.pdf)**

**EU CE RoHS (CE-DoC-00001-RoHS.pdf)**